

LEE COUNTY AST

Map 1

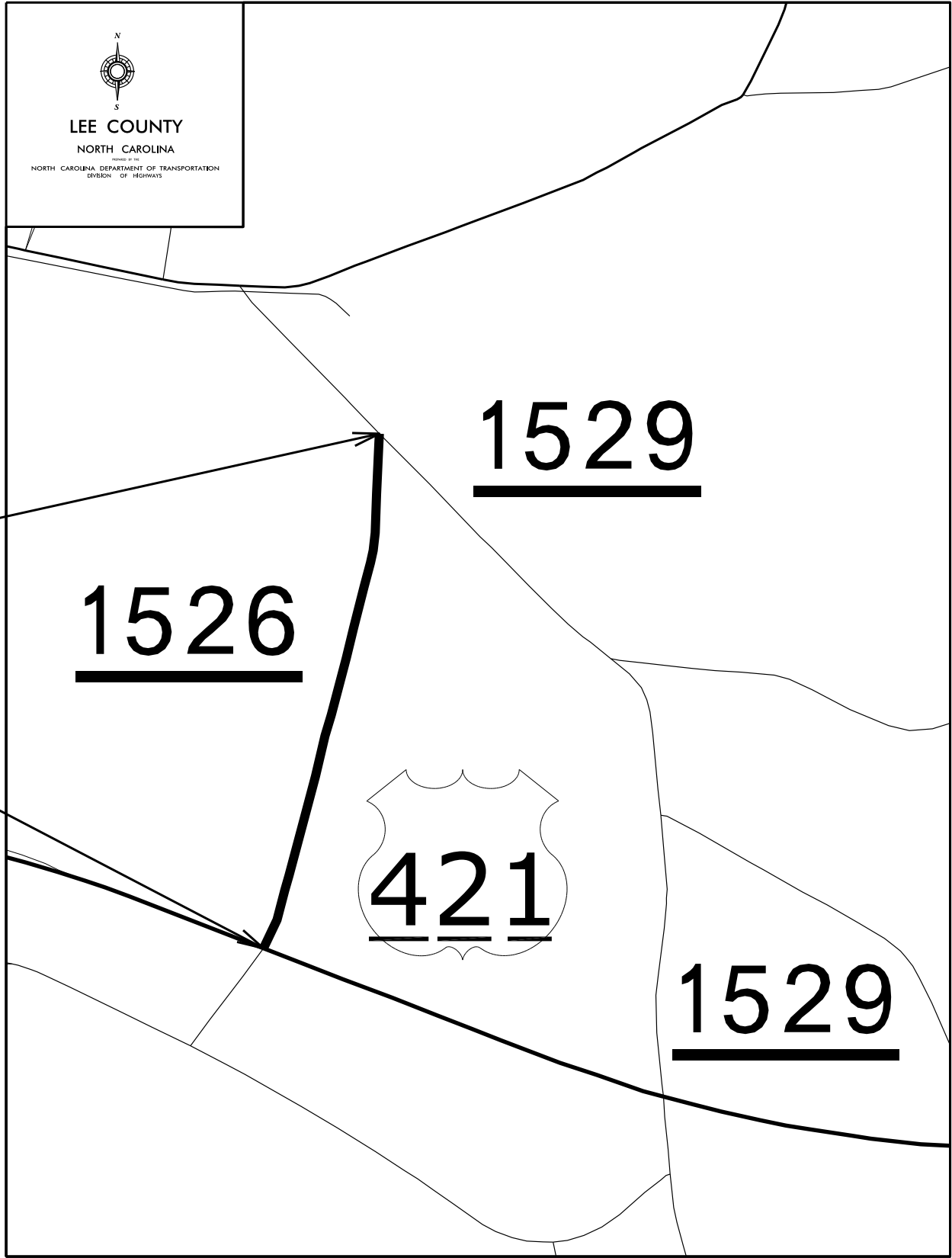

Map 2

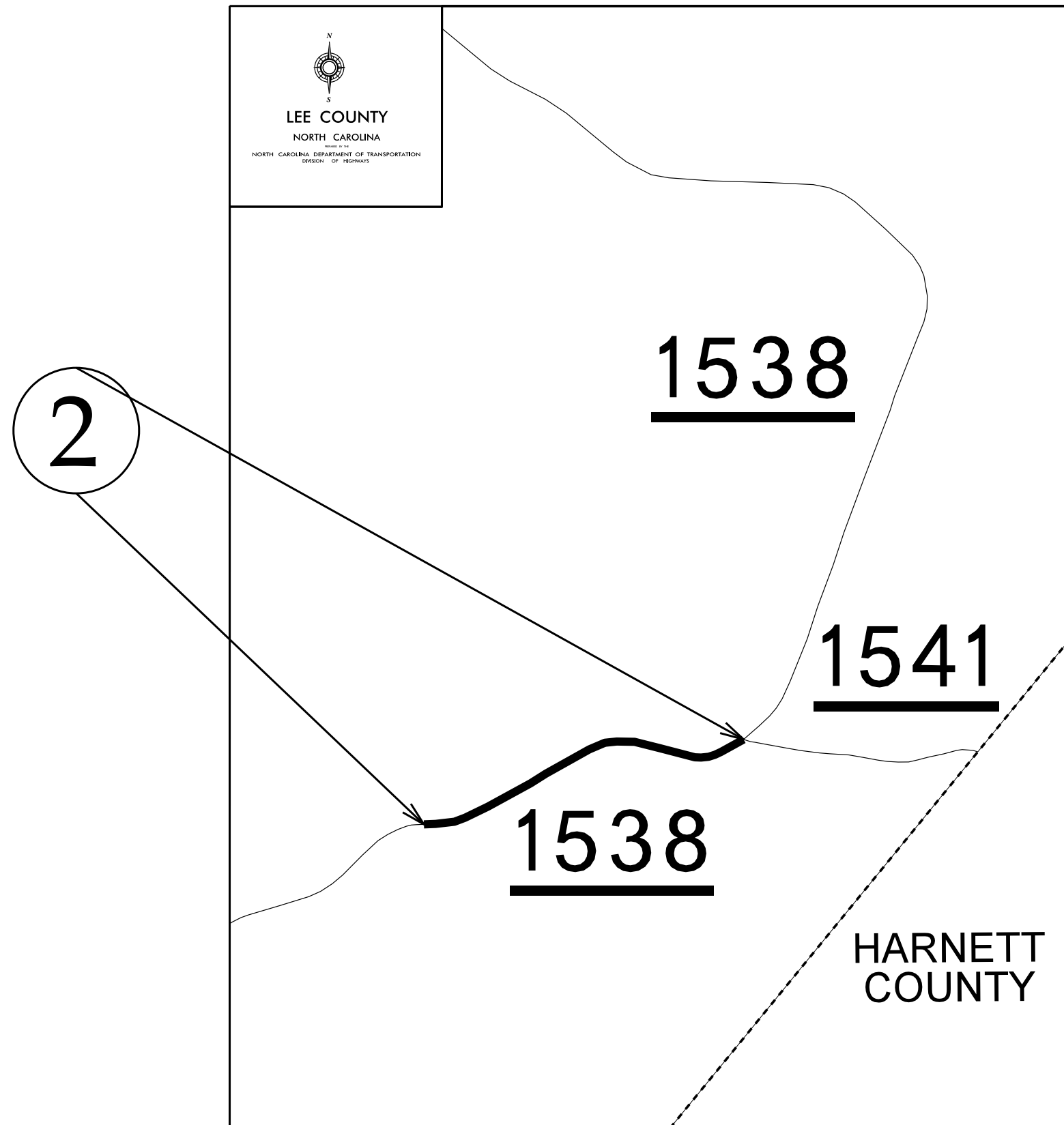

Map 3

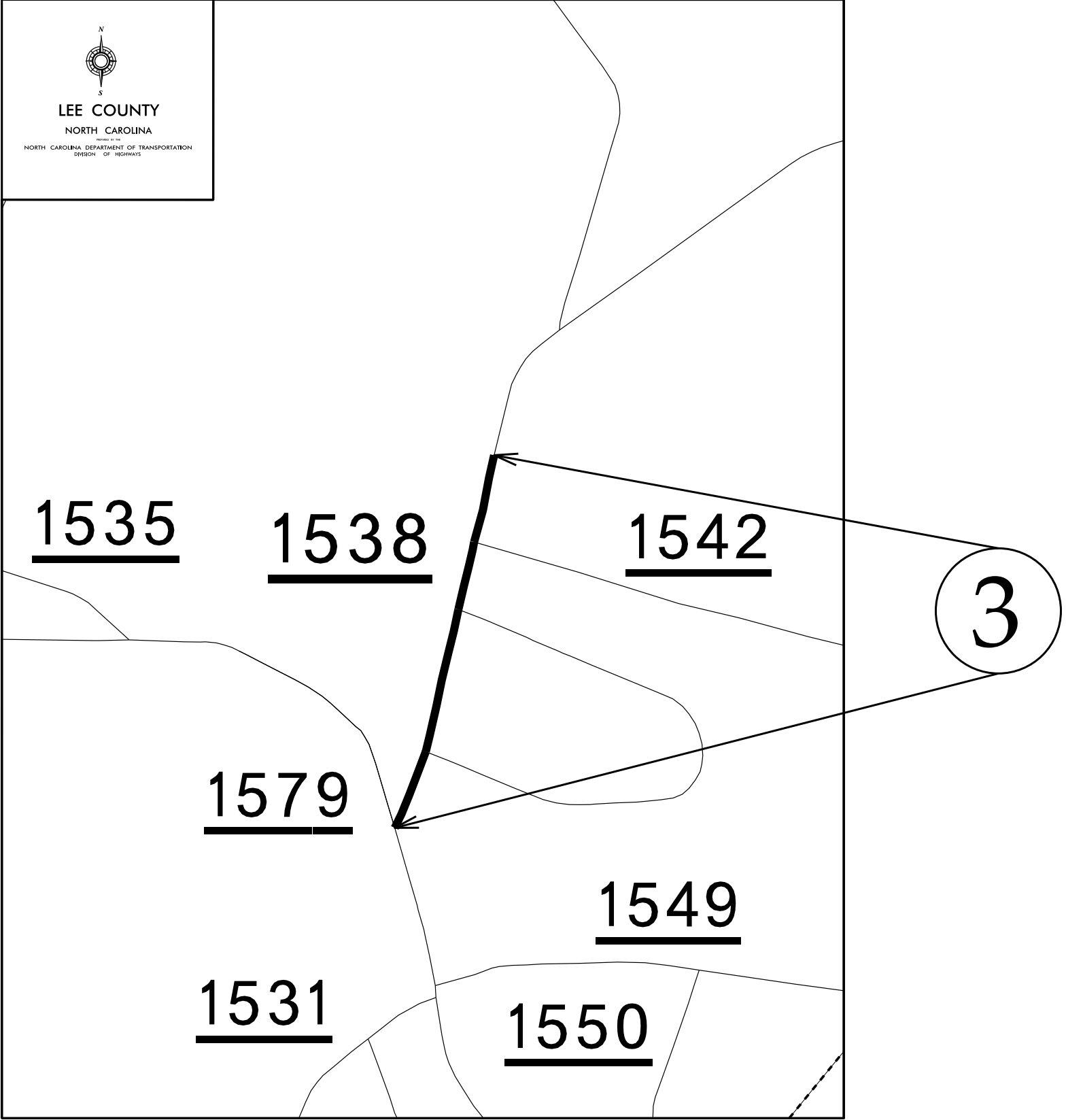

Map 4

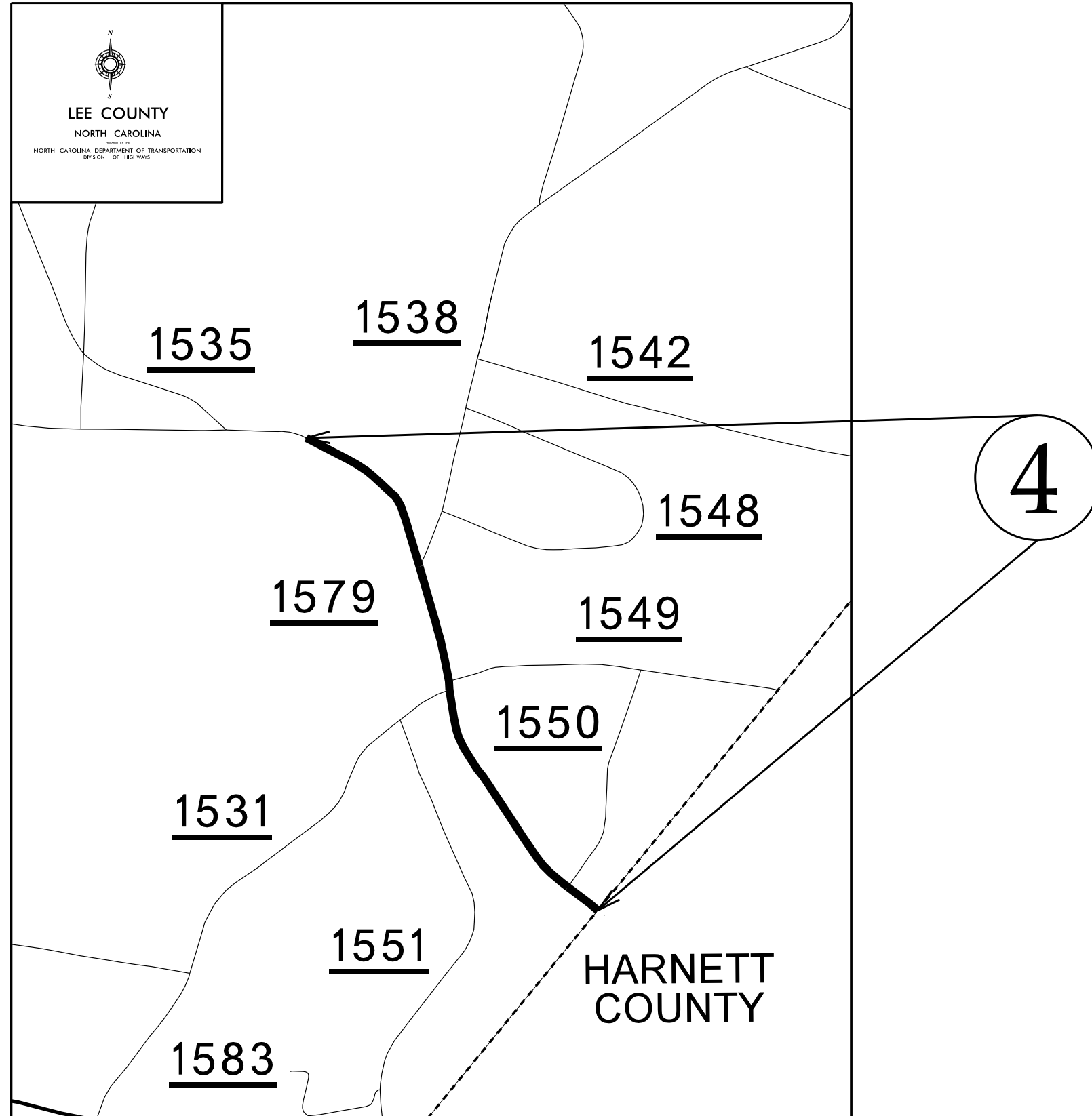

Map 5

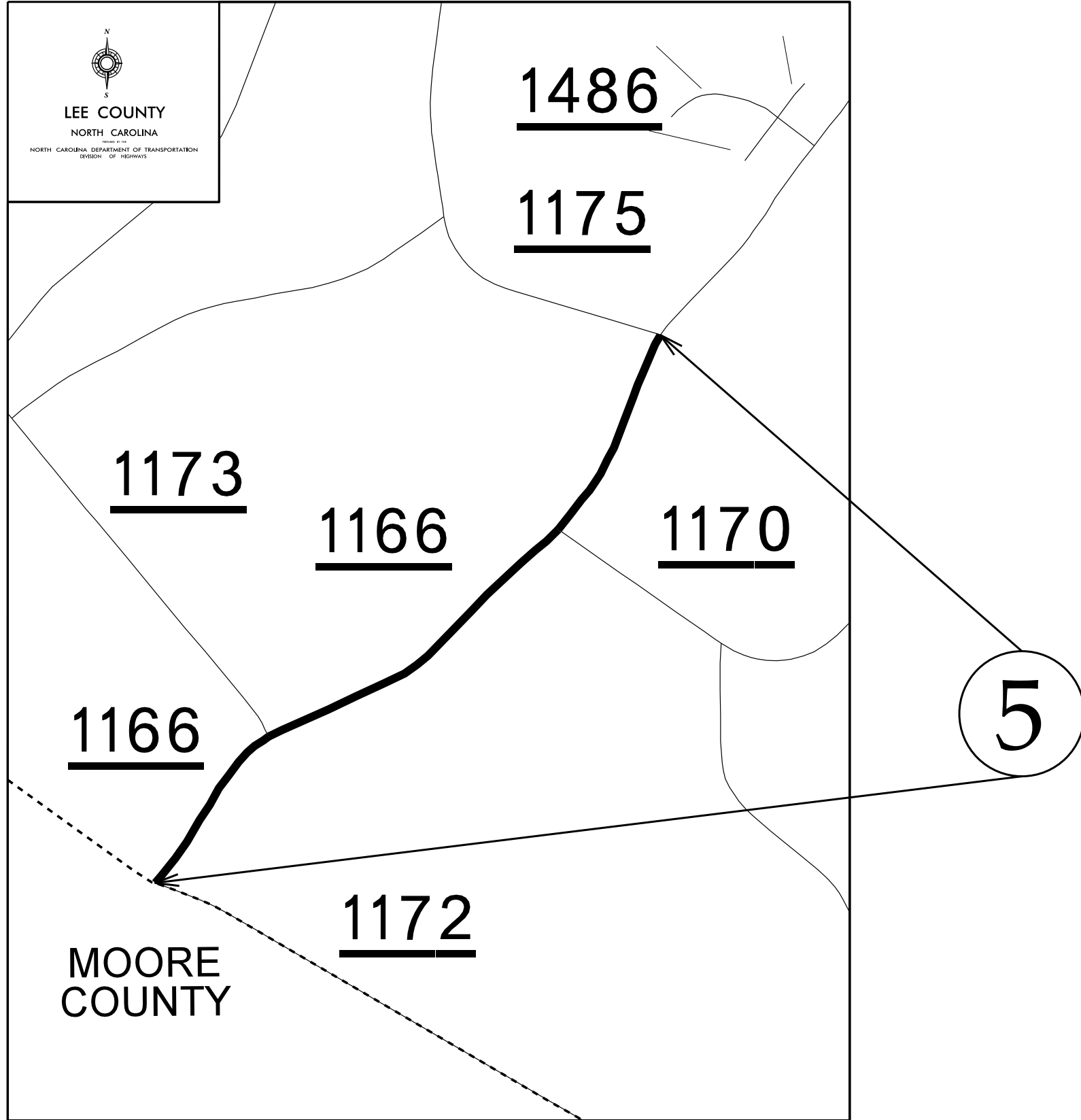

Map 6

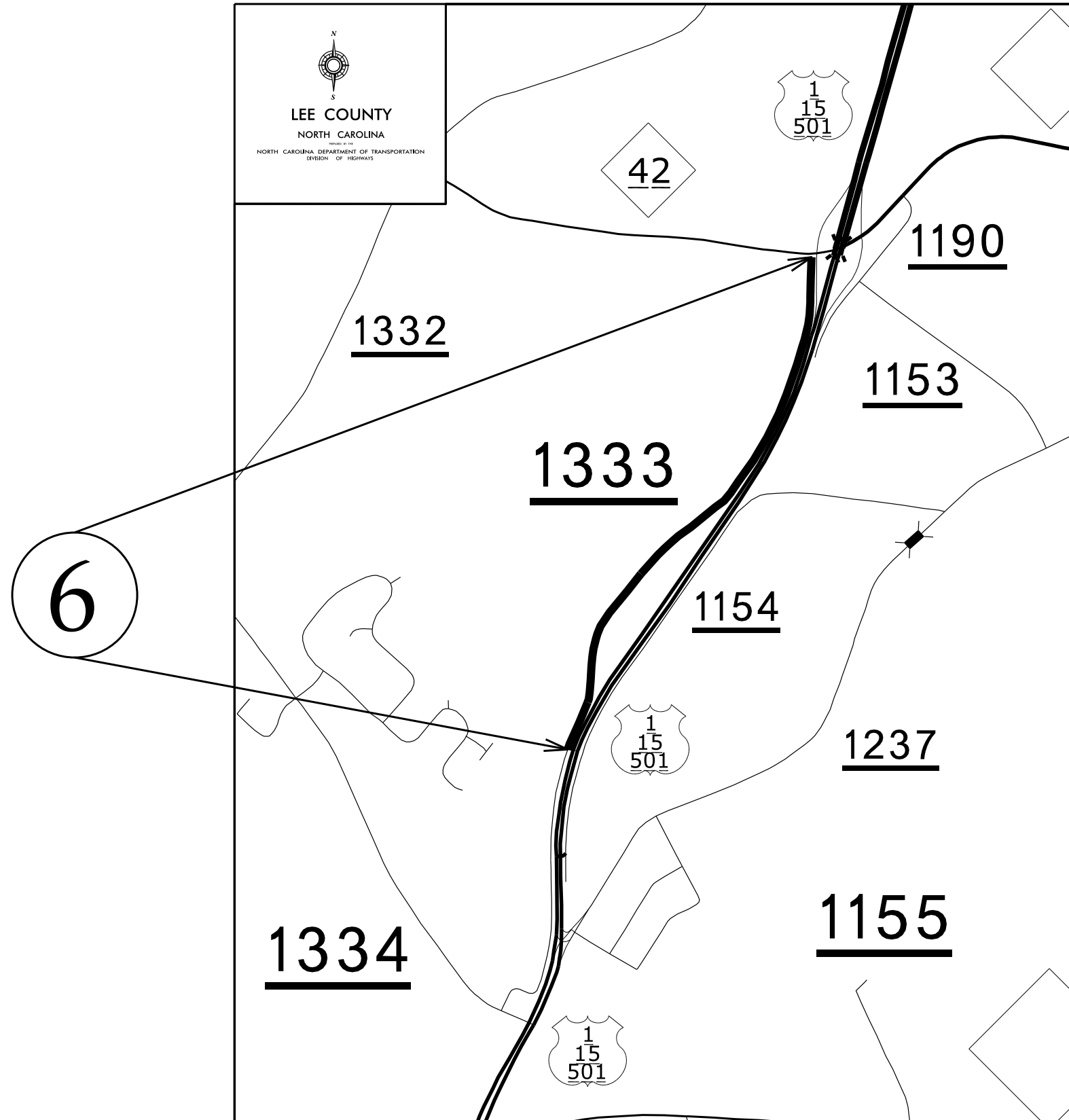

Map 7

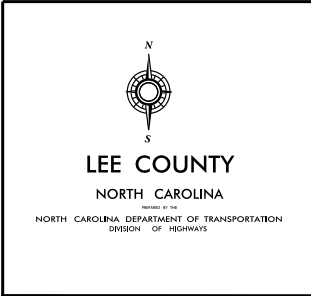
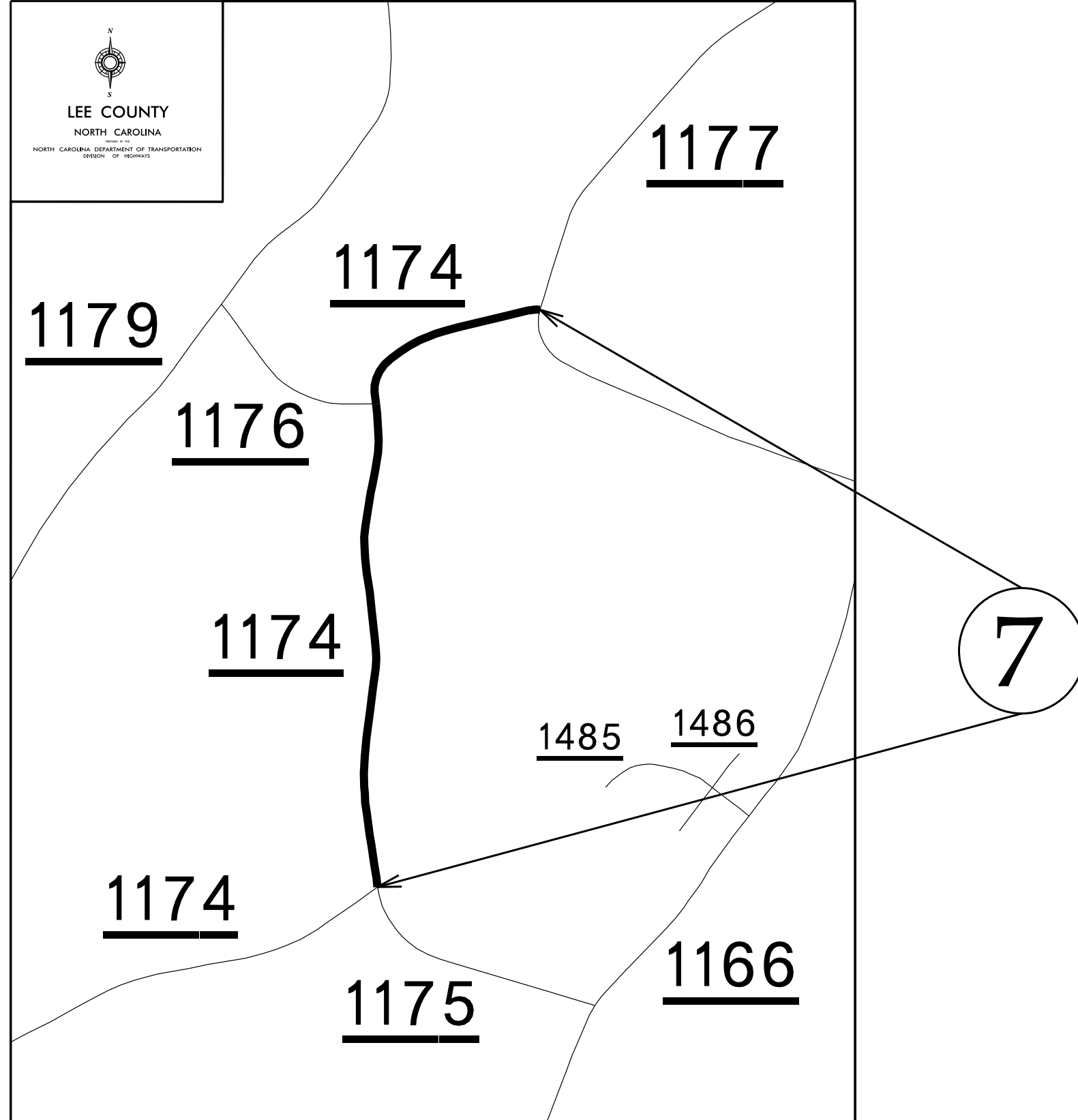

Map 8

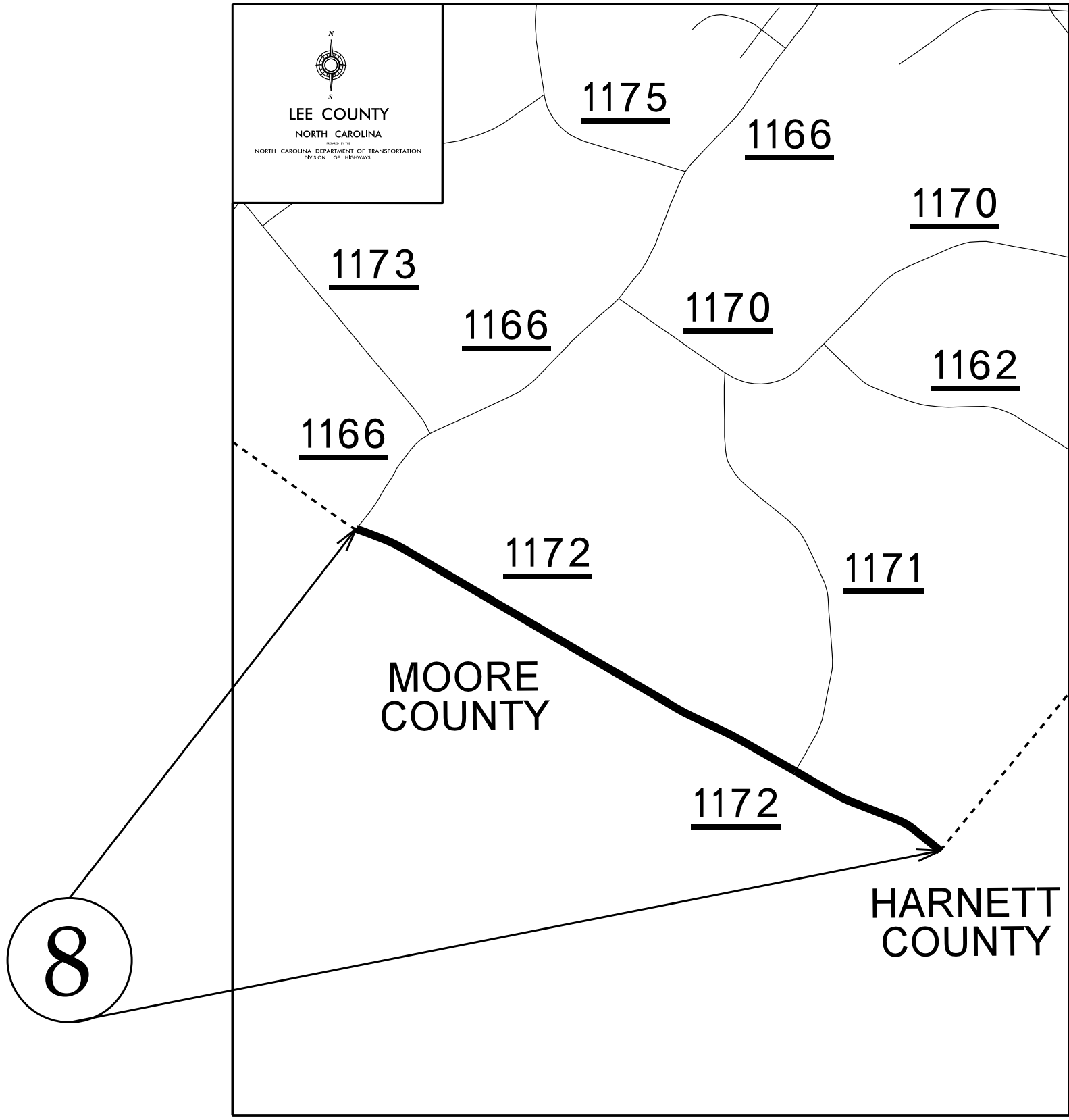

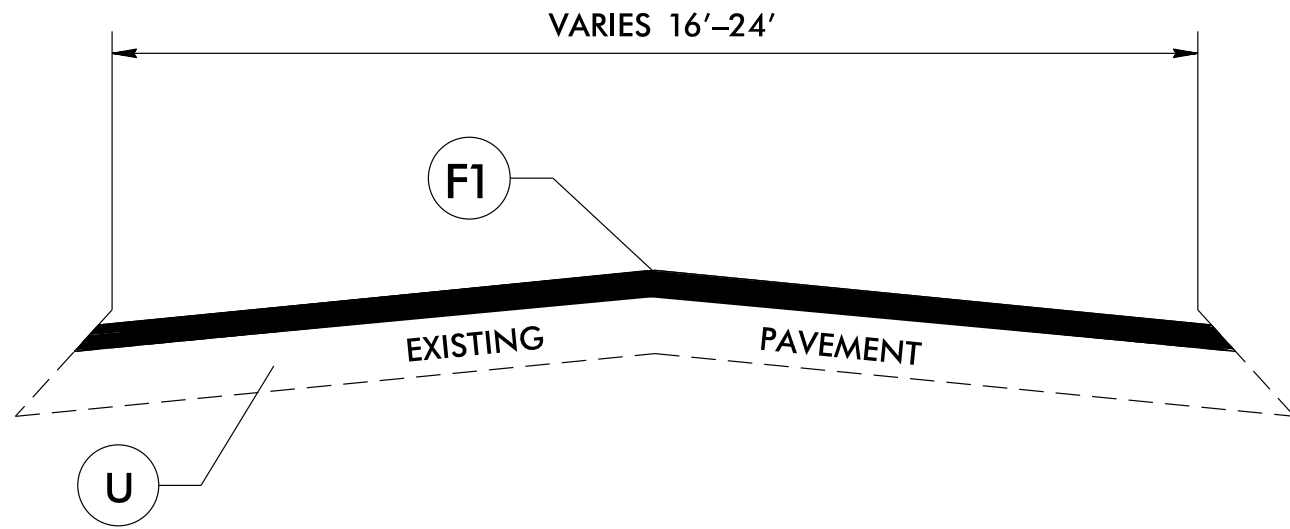

TYPICAL SECTION NO. 1

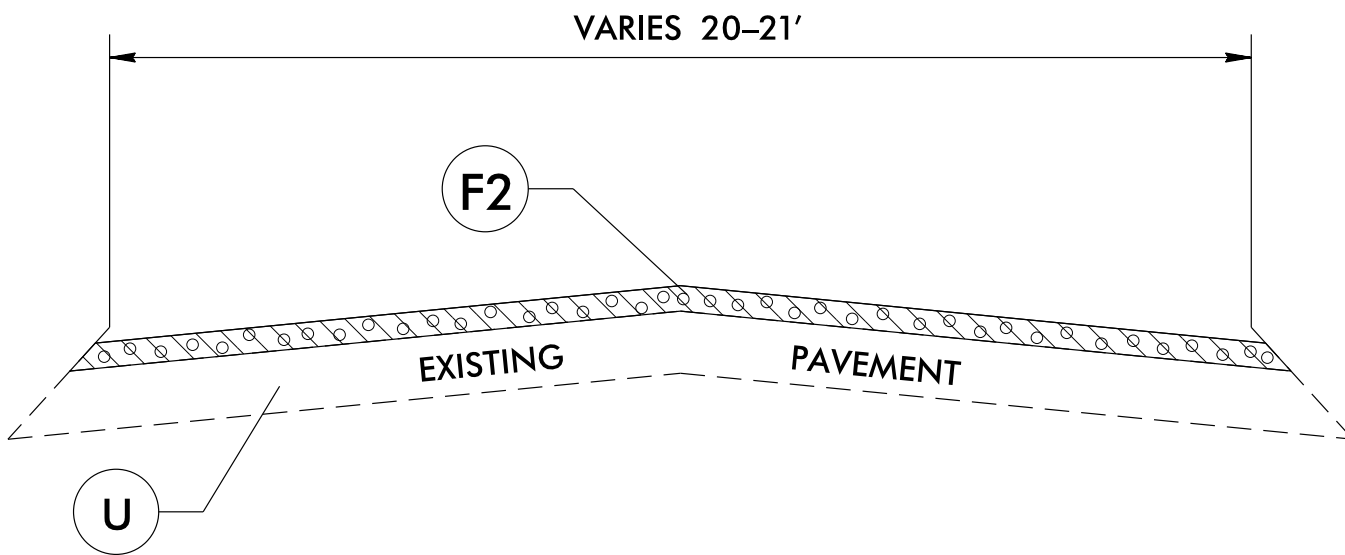

TYPICAL SECTION NO. 2

PAVEMENT SCHEDULE

D1	PROP. APPROX. 2.5" ASPHALT CONCRETE INTERMEDIATE COURSE, TYPE I19.0-C, AT AN AVERAGE RATE OF 285 LBS. PER SQ. YD.
F1	PROP. ASPHALT SURFACE TREATMENT DOUBLE SEAL
F2	PROP. LATEX MODIFIED MICROSURFACING, TYPE II, AT A RATE OF 18 TO 22 LBS. PER SQ. YD.
S	AGGREGATE SHOULDER BORROW
U	EXISTING PAVEMENT

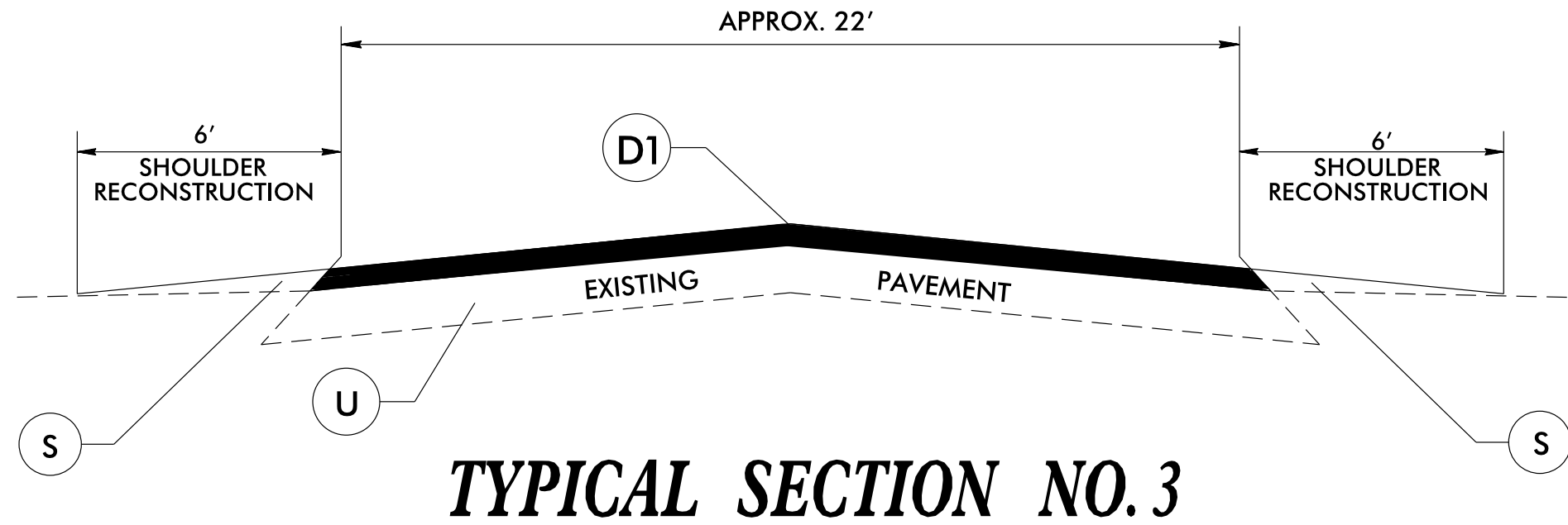

PAVEMENT SCHEDULE	
D1	PROP. APPROX. 2.5" ASPHALT CONCRETE INTERMEDIATE COURSE, TYPE I19.0-C, AT AN AVERAGE RATE OF 285 LBS. PER SQ. YD.
F1	PROP. ASPHALT SURFACE TREATMENT DOUBLE SEAL
F2	PROP. LATEX MODIFIED MICROSURFACING, TYPE II, AT A RATE OF 18 TO 22 LBS. PER SQ. YD.
S	AGGREGATE SHOULDER BORROW
U	EXISTING PAVEMENT

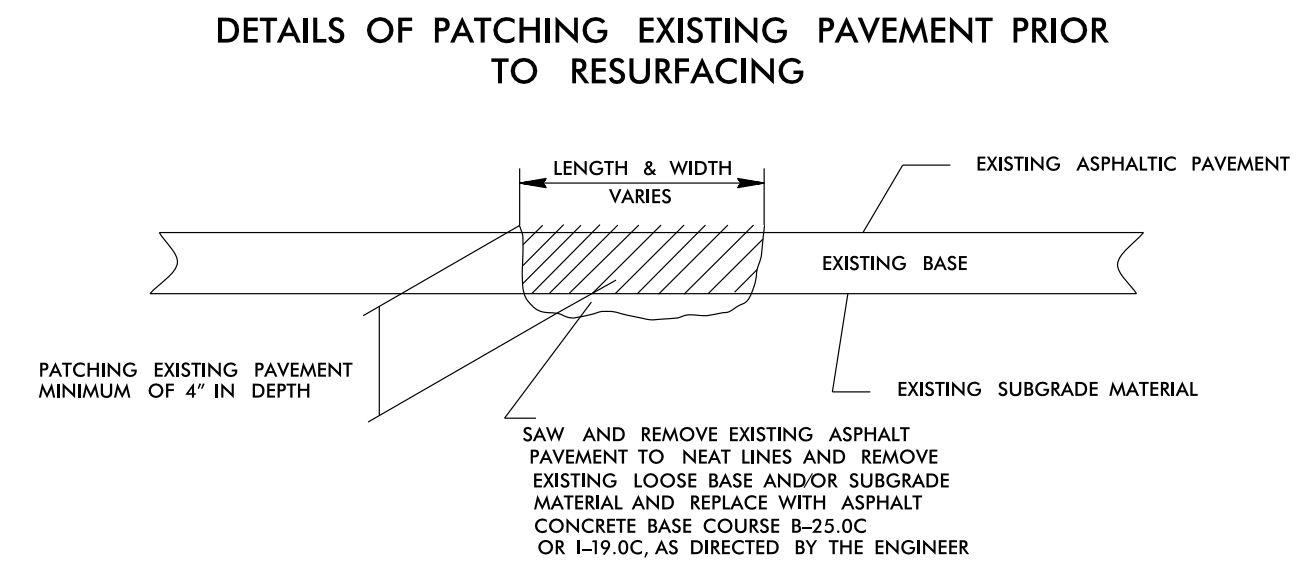

PROJECT NO.	SHEET NO.	TOTAL NO.
2024CPT.08.15.20532, 8.205311	12	

SUMMARY OF QUANTITIES

PROJECT NO	COUNTY	MAP NO	ROUTE	DESCRIPTION	TYP NO	LANES	LANE TYPE	FINAL SURFACE TESTING REQUIRED	WARM MIX ASPHALT REQUIRED	LENGTH	WIDTH	BEGIN MP	END MP	1245000000-E	1260000000-E	1503000000-E	1575000000-E	1704000000-E	1803500000-E	1838000000-E	1838500000-N	1891000000-E								
														SHOULDER RECONSTRUCTION	AGGREGATE SHOULDER BORROW	INTERMEDIATE COURSE, I19.0C	ASPHALT BINDER FOR PLANT MIX	PATCHING EXISTING PAVEMENT	ASPHALT SURFACE TREATMENT, DOUBLE SEAL	EMULSION FOR ASPHALT SURFACE TREATMENT	VACUUM TRUCK	GENERIC PAVING ITEM - LATEX MODIFIED MICROSURFACING, TYPE II								
														SMI	TON	TONS	TONS	TONS	SY	GAL	WK	SY								
2024CPT.08.15.20532	Lee	1	SR-1526 / MT PISGAH CHURCH RD	FROM PVMT JT AT US 421 TO PVMT JT AT SR 1529 (COX MILL RD)	2	2	2WU	NO	NO	0.82	22	0.2	1.02									10,583								
TOTAL FOR MAP NO. 1														0.82											10,583					
2024CPT.08.15.20532	Lee	2	SR-1538 / BUCKHORN RD	FROM PVMT JT AT SR 1541 (DANIELS CREEK RD) TO PVMT JT AT HOWARD FARM RD	1,3	2	2WU	NO	NO	0.58	22	5.7	6.28	1.16	165.00				7,486.00	4,117	1.00									
TOTAL FOR MAP NO. 2														0.58							1.16	165.00		7,486.00	4,117	1.00				
2024CPT.08.15.20532	Lee	3	SR-1538 / E HARRINGTON AV	FROM PVMT JT AT CITY LIMITS TO PVMT JT AT SR 1579 (S MAIN ST)	2	2	2WU	NO	NO	0.62	28	10.17	10.79									11,203								
TOTAL FOR MAP NO. 3														0.62													11,203			
2024CPT.08.15.20532	Lee	4	SR-1579 / S MAIN ST	FROM HARNETT COUNTY LINE TO END OF R-3830 PROJECT LIMIT (APPROXIMATELY 150' WEST OF MILTON AVE)	2	2	2WU	NO	NO	1.36	40	0	1.36									35,200								
TOTAL FOR MAP NO. 4														1.36												35,200				
2024CPT.08.15.20532	Lee	5	SR-1166 / NICHOLSON RD	FROM MOORE COUNTY LINE TO PVMT JT AT PILSON RD	2	2	2WU	NO	NO	1.86	24	0	1.86									28,808								
TOTAL FOR MAP NO. 5														1.86												28,808				
TOTAL FOR PROJ NO. 2024CPT.08.15.20532														5.24								1.16	165.00		7,486.00	4,117	1.00	85,794		
8.205311	Lee	1	SR-1526 / MT PISGAH CHURCH RD	FROM PVMT JT AT US 421 TO PVMT JT AT SR 1529 (COX MILL RD)	2	2	2WU	NO	NO	0.82	22	0.2	1.02					2	50											
TOTAL FOR MAP NO. 1														0.82									2	50						
8.205311	Lee	2	SR-1538 / BUCKHORN RD	FROM PVMT JT AT SR 1541 (DANIELS CREEK RD) TO PVMT JT AT HOWARD FARM RD	1,3	2	2WU	NO	NO	0.58	22	5.7	6.28			1,280	63	25												
TOTAL FOR MAP NO. 2														0.58							1,280	63	25							
8.205311	Lee	3	SR-1538 / E HARRINGTON AV	FROM PVMT JT AT CITY LIMITS TO PVMT JT AT SR 1579 (S MAIN ST)	2	2	2WU	NO	NO	0.62	28	10.17	10.79					1	25											
TOTAL FOR MAP NO. 3														0.62								1	25							
8.205311	Lee	4	SR-1579 / S MAIN ST	FROM HARNETT COUNTY LINE TO END OF R-3830 PROJECT LIMIT (APPROXIMATELY 150' WEST OF MILTON AVE)	2	2	2WU	NO	NO	1.5	40	0	1.5					3	65											
TOTAL FOR MAP NO. 4														1.5								3	65							
8.205311	Lee	5	SR-1166 / NICHOLSON RD	FROM MOORE COUNTY LINE TO PVMT JT AT PILSON RD	2	2	2WU	NO	NO	1.86	24	0	1.86					4	75											
TOTAL FOR MAP NO. 5														1.86								4	75							
8.205311	Lee	6	SR-1333 / WESTOVER DR	FROM PAV. JOINT AT ACCESS RD AT US1 (1.37 MILE FROM CUL-DE-SAC) TO CUL-DE-SAC END OF MAINT.	1	2	2WU	NO	NO	1.37	21	0.03	1.4					7	140	18,565.00	10,212									
TOTAL FOR MAP NO. 6														1.37								7	140	18,565.00	10,212					
8.205311	Lee	7	SR-1174 / PILSON RD	FROM PAV. JOINT AT SR 1174 (SELLARS RD) TO PAV. JOINT AT SR 1177 (SANDERS RD)	1	2	2WU	NO	NO	1.65	21	1.17	2.82					7	150	20,328.00	11,180									
TOTAL FOR MAP NO. 7														1.65								7	150	20,328.00	11,180					
8.205311	Lee	8	SR-1172 / COUNTY LINE RD	FROM LEE/HARNETT COUNTY LINE TO SR2001(BASS RD) INTERSECTION	1	2	2WU	NO	NO	2.74	18	0	2.74					5	100	28,934.00	15,914									
TOTAL FOR MAP NO. 8														2.74								5	100	28,934.00	15,914					
TOTAL FOR PROJ NO. 8.205311														11.14								1,280	92	630	67,827.00	37,306	3.00			
GRAND TOTAL														16.38								1.16	165.00	1,280	92	630	75,313.00	41,423	4.00	85,794

PROJECT NO.	SHEET NO.	TOTAL NO.
2024CPT.08.15.20532, 8.205311	13	

THERMOPLASTIC AND PAINT QUANTITIES

PROJECT NO	COUNTY	MAP NO	ROUTE	DESCRIPTION	TYP NO	LANES	LANE TYPE	LENGTH	WIDTH	BEGIN MP	END MP	441300000-E	445700000-N	468800000-E	469500000-E	470900000-E	472000000-E	472500000-E				481500000-E		485000000-E	486000000-E	487000000-E	487500000-N	490510000-N			
												WORK ZONE ADVANCE/GENERAL WARNING SIGNING	TEMPORARY TRAFFIC CONTROL	6" X 90 M WHITE THERMO	6" X 90 M YELLOW THERMO	8" X 90 M WHITE THERMO	24" X 90 M WHITE THERMO	THERMO MSG SCHOOL 90 M	THERMO STR & RT ARROW 90 M	THERMO RT ARROW 90 M	THERMO LT ARROW 90 M	THERMO STR ARROW 90 M	6" WHITE PAINT	6" YELLOW PAINT	4" LINE REMOVAL	8" LINE REMOVAL	24" LINE REMOVAL	REMOVAL OF PAVEMENT MARKING SYMBOLS & CHARACTERS	NON-CAST IRON SNOWPLOWABLE PAVEMENT MARKER Y&Y	NON-CAST IRON SNOWPLOWABLE PAVEMENT MARKER C&R	
MI	FT	SF	LS	LF	LF	LF	LF	EA	EA	EA	EA	EA	EA	EA	EA	EA	EA	EA	EA	EA	EA	EA	EA	EA	EA	EA	EA	EA			
2024CPT.08.15.20532	Lee	1	SR-1526 / MT PISGAH CHURCH RD	FROM PVMT JT AT US 421 TO PVMT JT AT SR 1529 (COX MILL RD)	2	2	2WU	0.82	22	0.2	1.02	92										17,646	14,824	16,235							
TOTAL FOR MAP NO. 1							0.82					92										17,646	14,824	16,235							
2024CPT.08.15.20532	Lee	2	SR-1538 / BUCKHORN RD	FROM PVMT JT AT SR 1541 (DANIELS CREEK RD) TO PVMT JT AT HOWARD FARM RD	1,3	2	2WU	0.58	22	5.7	6.28	65										12,482	12,900								
TOTAL FOR MAP NO. 2							0.58					65										12,482	12,900								
2024CPT.08.15.20532	Lee	3	SR-1538 / E HARRINGTON AV	FROM PVMT JT AT CITY LIMITS TO PVMT JT AT SR 1579 (S MAIN ST)	2	2	2WU	0.62	28	10.17	10.79	70										8,184	8,153	16,338							
TOTAL FOR MAP NO. 3							0.62					70										8,184	8,153	16,338							
2024CPT.08.15.20532	Lee	4	SR-1579 / S MAIN ST	FROM HARNETT COUNTY LINE TO END OF R-3830 PROJECT LIMIT (APPROXIMATELY 150' WEST OF MILTON AVE)	2	2	2WU	1.36	40	0	1.36	170													28,665	250	480	33	120	10	
TOTAL FOR MAP NO. 4							1.36					170	6,640	22,025	250	480	12	1	3	14	3				28,665	250	480	33	120	10	
2024CPT.08.15.20532	Lee	5	SR-1166 / NICHOLSON RD	FROM MOORE COUNTY LINE TO PVMT JT AT PILSON RD	2	2	2WU	1.86	24	0	1.86	209										40,027	39,500	39,764							
TOTAL FOR MAP NO. 5							1.86					209										40,027	39,500	39,764							
TOTAL FOR PROJ NO. 2024CPT.08.15.20532							5.24					606	1,000	6,640	22,025	250	480	12	1	3	14	3	78,339	75,377	101,002	250	480	33	120	10	
														28,665								21			153,716					130	
8.205311	Lee	1	SR-1526 / MT PISGAH CHURCH RD	FROM PVMT JT AT US 421 TO PVMT JT AT SR 1529 (COX MILL RD)	2	2	2WU	0.82	22	0.2	1.02																				
TOTAL FOR MAP NO. 1							0.82																								
8.205311	Lee	2	SR-1538 / BUCKHORN RD	FROM PVMT JT AT SR 1541 (DANIELS CREEK RD) TO PVMT JT AT HOWARD FARM RD	1,3	2	2WU	0.58	22	5.7	6.28																				
TOTAL FOR MAP NO. 2							0.58																								
8.205311	Lee	3	SR-1538 / E HARRINGTON AV	FROM PVMT JT AT CITY LIMITS TO PVMT JT AT SR 1579 (S MAIN ST)	2	2	2WU	0.62	28	10.17	10.79																				
TOTAL FOR MAP NO. 3							0.62																								
8.205311	Lee	4	SR-1579 / S MAIN ST	FROM HARNETT COUNTY LINE TO END OF R-3830 PROJECT LIMIT (APPROXIMATELY 150' WEST OF MILTON AVE)	2	2	2WU	1.5	40	0	1.5																				
TOTAL FOR MAP NO. 4							1.5																								
8.205311	Lee	5	SR-1166 / NICHOLSON RD	FROM MOORE COUNTY LINE TO PVMT JT AT PILSON RD	2	2	2WU	1.86	24	0	1.86																				
TOTAL FOR MAP NO. 5							1.86																								
8.205311	Lee	6	SR-1333 / WESTOVER DR	FROM PAV. JOINT AT ACCESS RD AT US1 (1.37 MILE FROM CUL-DE-SAC) TO CUL-DE-SAC END OF MAINT.	1	2	2WU	1.37	21	0.03	1.4	155										29,482	28,938								
TOTAL FOR MAP NO. 6							1.37					155											29,482	28,938							
8.205311	Lee	7	SR-1174 / PILSON RD	FROM PAV. JOINT AT SR 1174 (SELLARS RD) TO PAV. JOINT AT SR 1177 (SANDERS RD)	1	2	2WU	1.65	21	1.17	2.82	185										35,508	35,509								
TOTAL FOR MAP NO. 7							1.65					185											35,508	35,509							
8.205311	Lee	8	SR-1172 / COUNTY LINE RD	FROM LEE/HARNETT COUNTY LINE TO SR2001(BASS RD) INTERSECTION	1	2	2WU	2.74	18	0	2.74	307										58,965	59,210								
TOTAL FOR MAP NO. 8							2.74					307											58,965	59,210							
TOTAL FOR PROJ NO. 8.205311							11.14					647	1,000										123,955	123,657							
GRAND TOTAL							16.38					1,253	1,000	6,640	22,025	250	480	12	1	3	14	3	202,294	199,034	101,002	250	480	33	120	10	
														28,665									21			401,328					130

SIGNING FOR ASPHALT SURFACE TREATMENT

LEGEND

- ◁ PORTABLE SIGN
- ┆ STATIONARY SIGN
- DIRECTION OF TRAFFIC FLOW

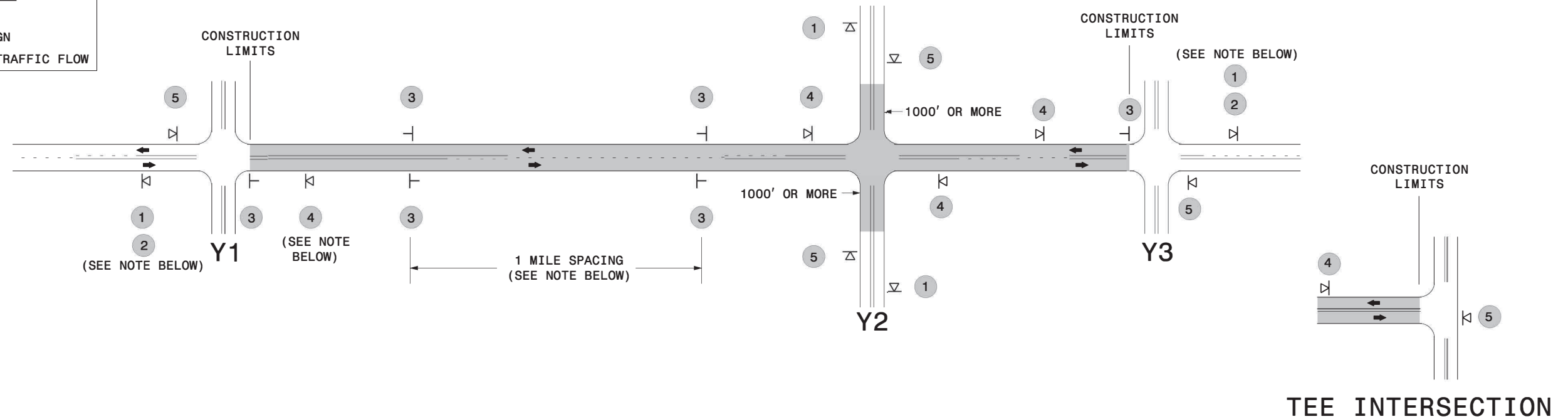

MAINLINE (-L-) SIGNING

-Y- LINE SIGNING

SIGNING NOTES AND PLACEMENT PER DIRECTION	1		- PLACE 1000' PRIOR TO BEGINNING OF CONSTRUCTION LIMITS. ONLY USED ON -Y- LINES IF RESURFACING LIMITS EXTEND 1000' ALONG -Y- LINE.	<p>STATIONARY SIGNING NOT REQUIRED FOR THE FOLLOWING -Y- LINE CONDITIONS:</p> <ol style="list-style-type: none"> 1) LESS THAN 1000' OF RESURFACING ALONG -Y- LINE 2) SUBDIVISION ROADS 3) DEAD END ROADS <p>WHEN PAVING/CONSTRUCTION ACTIVITIES PROCEED ACROSS AN UNSIGNED -Y- LINE, PORTABLE ADVANCE WARNING SIGNS SHALL BE USED ALONG THE -Y- LINE AS SHOWN BELOW. REMOVE UPON COMPLETION OF WORK.</p> <div style="display: flex; justify-content: space-around;"> <div style="text-align: center;"> W20-1 48" X 48" PLACED 500' IN ADVANCE OF FLAGGER. </div> <div style="text-align: center;"> W20-7 A 48" X 48" PLACED 250' IN ADVANCE OF FLAGGER. </div> </div>
	2		- SIGN #2 ONLY USED WHEN RESURFACING LIMITS ARE 2 OR MORE MILES IN LENGTH. ROUND UP TO THE NEAREST WHOLE NUMBER. DO NOT USE FRACTIONAL OR DECIMAL NUMBERS.	
	3	 	- ALTERNATE THE FOLLOWING TWO SIGNS: - STARTING WITH "LOOSE GRAVEL" (W8-7) FOLLOWED BY "UNMARKED PAVEMENT". - PLACE INITIALLY AT THE CONSTRUCTION LIMITS AND SPACED 1 MILE APART THEREAFTER. - AT TEE INTERSECTIONS INSTALL INITIALLY 0.5 MILE FROM INTERSECTION AND SPACE 1 MILE APART THEREAFTER.	
	4		- THESE ARE FOR -Y- LINES THAT ARE "THROUGH" ROADWAYS. DEAD END AND SUBDIVISION ROADS ARE NOT "THROUGH" ROADWAYS. - INSTALL 500' +/- FROM EACH -Y- LINE APPROACH AS SHOWN ABOVE. - FOR MULTIPLE -Y- LINES THAT ARE SEPARATED BY 0.25 MILES OR LESS, TREAT AS A SINGLE UNIT AND INSTALL WITHIN 500' OF EACH APPROACH. - A MAXIMUM OF 2 SIGN SETS PER MILE. DO NOT INSTALL WHEN -Y- LINES ARE WITHIN 0.5 MILES FROM "END ROAD WORK" SIGN.	
	5		PLACE 500' FOLLOWING THE END OF CONSTRUCTION LIMITS OR AS SHOWN WHEN WORK ENDS AT A 3-WAY TEE INTERSECTION.	

THE ABOVE SIGNS ARE ALL THAT ARE REQUIRED FOR A CONTRACTOR TO BEGIN A RESURFACING CONTRACT. ANY ADDITIONAL SIGNS REQUESTED BY NCDOT DIVISIONS SHALL BE INSTALLED WITHIN 7 BUSINESS DAYS OF THE START OF CONTRACT WORK.

MAPS LESS THAN 2 MILES

FOR AST RESURFACING MAPS WITH CONSTRUCTION LIMITS LESS THAN 2 MILES IN LENGTH, USE A STATIONARY "LOOSE GRAVEL" SIGN AT THE BEGINNING CONSTRUCTION LIMIT FOLLOWED BY AN "UNMARKED PAVEMENT" SIGN MIDWAY THROUGH AND AN "END ROAD WORK" SIGN AT THE END CONSTRUCTION LIMIT.



ADVANCE WARNING SIGNS FOR 2-LANE ROADWAY ASPHALT SURFACE TREATMENT